

THE POWERLINE SERIES

12-00138

Equipment line filter

Features

- Built in surge suppression
- High surge capability
- Compact design
- Effective filtration
- Fire hazard protection
- Power indication

A line filter with surge suppression for effective protection against induced lightning transients and mains borne noise. Intended for OEM applications, the Filtertube is a single stud mounting with wire leads on the input and output. Clearline's unique built-in thermal protection devices eliminates fire hazards.



Specifications

Max continuous voltage	275V 50Hz
Nom. input voltage	230V AC 50Hz
Max continuous current	10A
Earth leakage current	1,5mA
Max discharge current ismax (8/20)	8kA
Response time	<25ns
Filtration	refer to graph 1
Indication	Neon Lamp
Temperature range	-20 C to +70 C
Connections	Wire leads
Standards compliance	IEC61643-1

Filter characteristics

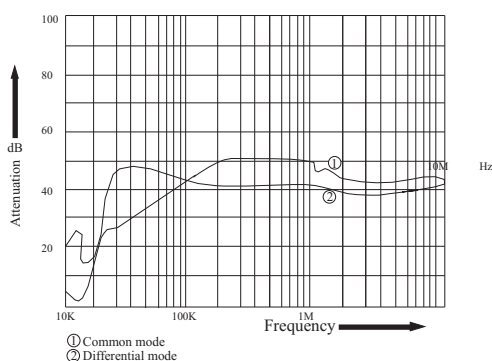

Dimensions

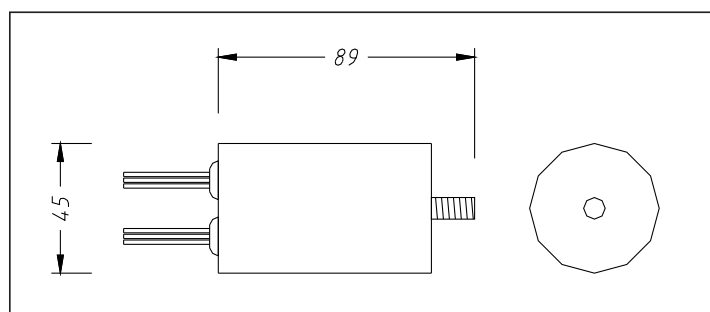

Designed and Manufactured by:

Clearline Protection Systems (Pty) Ltd

Roan Crescent Corporate Park North, Old Pta Road, Midrand, South Africa

PO. Box 5985, Halfway House, 1685

Tel: +27 (0) 11 848-1100

Fax: +27 (0) 11 314-3880

E-mail: sales@clearline.co.za

www.clearline.co.za

